Formiche

SMALL TABLES

Piero Lissoni



Description

Lightness and simplicity distinguish Formiche (Ants in English) complements. The slender support FRAME (making reference to the name), with its shape and finish, picks up the theme of the feet in the sofa system. The rounded support of pewter painted steel is connected by crosspiece to support the tops in different shapes, round, oval, or “kidney bean.” Various shapes and heights make it possible to compose different support systems. The tops themselves, made of transparent extra light glass, brushed light oak, titanium finish metal, or porcelain stoneware, Calacatta white or stone grey stone, have a fine thickness of 8 mm.

Technical information

Technical drawings

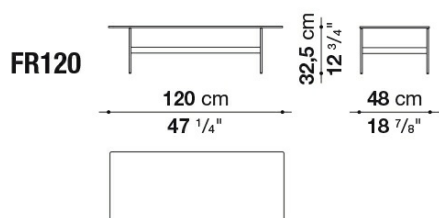

FR120

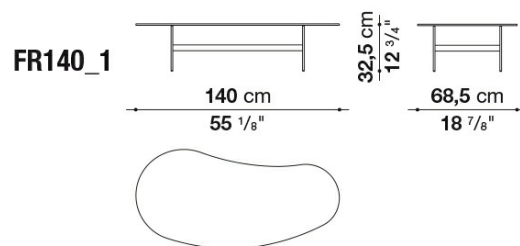

FR140_1

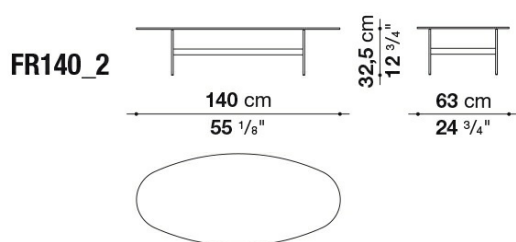

FR140_2

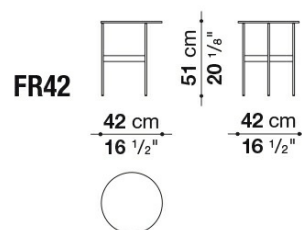

FR42

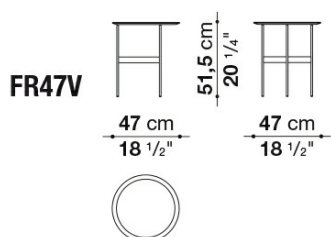

FR47V

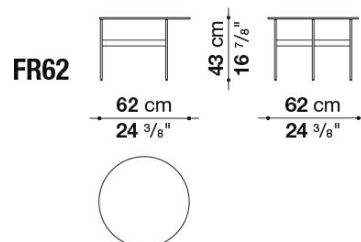

FR62

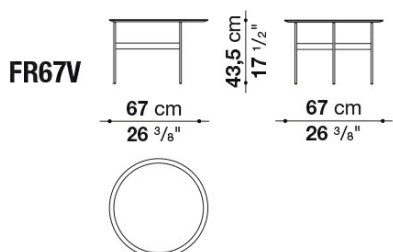

FR67V

B&B Italia reserves the right to make technological and aesthetic improvements to its models, including changes to the sizes and materials, without notice. The technical drawings do not define the details of the product. The measurements shown are indicative and may undergo changes. In particular, the dimensions relevant to the padded parts are subject to usage tolerances over time caused by the normal adjustment of the padding. For the specific information, please contact the dealer closest to you.