

53
(2')

up to
3000 (10')
standard

up to
30500
(100')
custom

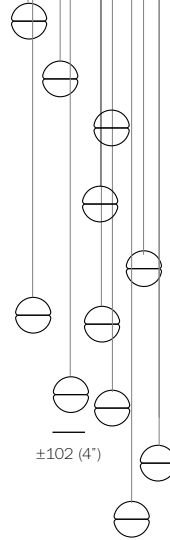

±102 (4')

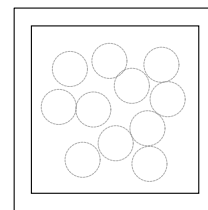

378 (15')

508 (20')

- PENDANTS: eleven
- MOUNTING: white powder coated square canopy 508mm (20') x 53mm (2") deep
- LAMPING: 1.5w LED or 10w xenon
- COAX: fixed lengths. 3000mm (10') standard / up to 30500mm (100') maximum
- MATERIALS: cast glass, blown borosilicate glass, braided metal coaxial cable, electrical components, white powder coated canopy
- WEIGHT: approximately 29.5kg (65lb)
- POWER SUPPLIES: integral

DESCRIPTION

14.11 is a random configuration of eleven 14 pendants hung from a square canopy. The drop lengths of the pendants are randomized between a client specified range of heights to variously cluster and scatter. The result is an ambient installation or field of light.

The 14 is an articulated, seamed cast glass sphere with a frosted cylindrical void that houses a low voltage lamp. Individual pendants are visually quite subtle, but gain tremendous strength when multiplied and clustered in large groups.

NOTES

- + Purchase replacement lamps online at www.bocci.com/shop/bulbs
- + Unless otherwise noted when ordering, all chandeliers will be outfitted to be xenon compatible.
- + As an alternative to a built-in power supply, Bocci recommends mounting power supplies remotely in an easily accessible and hidden location for ease of long-term maintenance.

US Patent # D556, 361
EU Patent # 000518394-0001

Made in Vancouver, Canada

Vancouver
sales@bocci.com
www.bocci.com

Berlin
europe@bocci.com
www.bocci.com

approx 29.5kg (65lb)

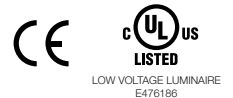

SQUARE

14.11

Design by Omer Arbel
PRODUCT SPECIFICATION

BOCCI

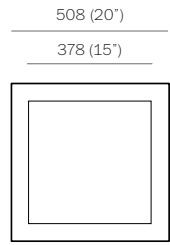

1

Note: All connections and power supplies are tested by our technicians before shipping. However, it is possible for ports/ power supplies to come loose or damage during shipping.

Test each port before installing canopy to ceiling to catch any loose connections or faulty power supplies.

Measure and mark the light fixture canopy position on the ceiling

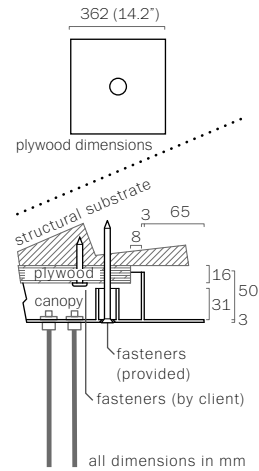

2

Note: The client is responsible for providing a robust 16mm (5/8") plywood backing or wood blocking to securely anchor to the structural substrate.

Connections from the plywood to the structural substrate are the client's responsibility.

Measure the plywood so that it fits within the canopy side walls (refer to detail above).

Anchor the plywood backing to the structural ceiling substrate.

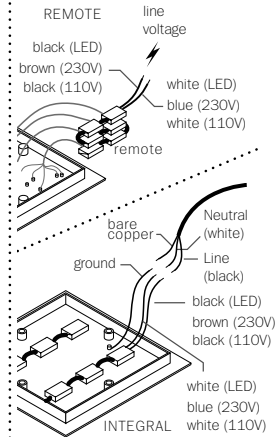

3

Connect power supplies to line voltage.

Xenon (110V) or LED: connect the black wire to black and white wire to white wire.

Xenon (230V): connect black wire to brown wire and white wire to blue wire.

For the ground connection, connect the green wire with yellow stripe to the bare copper wire or green wire in the junction box.

Note: Bocci strongly recommends mounting power supplies remotely in a close, accessible and hidden location for ease of long term maintenance. Installation to be done by certified personnel to ensure compliance with the code.

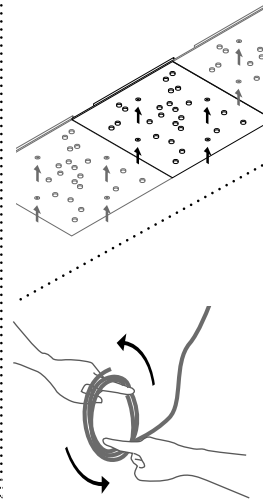

4

Anchor canopy into the plywood backing using the fasteners provided.

Turn power to fixture on.

Very carefully uncoil the braided coaxial cable in a spool like manner. Insert your index fingers into opposite sides of the roll then rotate your fingers around each other to unroll the coaxial cable.

Use patience: allow the cable to uncoil completely to avoid kinks.

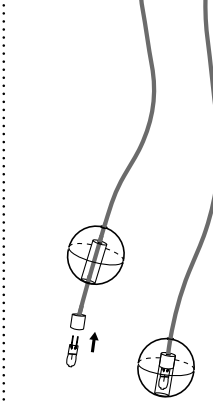

5

Bocci 10w xenon or 1.5w LED lamps included. Lamping is power supply specific.

Plug the lamp into the socket. Do not touch the lamp with your bare hands.

Note: when using a dimmer use only low voltage electronic dimmer.

The borosilicate tube is an integral part to the structure of the pendant. Please contact for replacement if it is damaged at any point.

6

Each pendant terminates in a "headphone jack" type connector, which plugs into a receiving receptacle in the canopy. Clients are encouraged to compose their own pendant configuration on site, thus creating a truly unique fixture. After plugging in each pendant, turn the threaded sheath into place by hand ensuring that it is adequately tightened. Tools are not required.

Check that each lamp is working properly as you go along by keeping power to the fixture on and lamps plugged in.

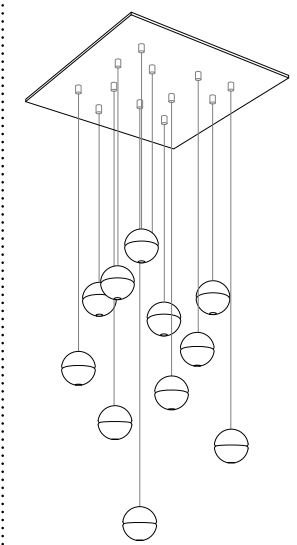
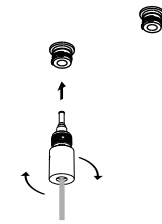

7

Clean fingerprints from surfaces.

For additional assistance, please contact Bocci:

Vancouver
sales@bocci.com
www.bocci.com

Berlin
europe@bocci.com
www.bocci.com

US Patent # D556, 361 EU
Patent # 000518394-0001

Made in Vancouver, Canada



SQUARE

14.11

Design by Omer Arbel
PRODUCT INSTALLATION INSTRUCTIONS

© 2020, Bocci Design and Manufacturing Inc. All rights reserved. Any inquiries should be directed to: info@bocci.com

BOCCI